

# Suggested Load Data

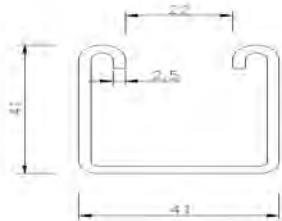

Pre Galvanised 41x41x2.5mm slotted strut  
**Loading Conditions:** Point Load at mid span

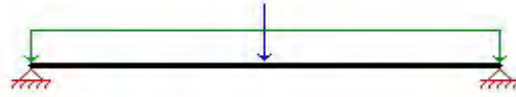

## Slotted 41x41x2.5mm thick

Beam Span (mm)	Ultimate Loading		Limit Def. Span/200		Limit Def. Span/360	
	Central Point Load (kg)	Total Def. (mm)	Central Point Load (kg)	Total Def. (mm)	Central Point load (kg)	Total Def. (mm)
250	805	0.2				
500	405	0.8				
750	270	1.8				
1000	205	3.3			175	2.8
1250	162	5.1			110	3.5
1500	136	7.4	137	7.5	76	4.2
1750	115.8	10.1	101	8.8	55	4.9
2000	101	13.2	75.9	10.0	41	5.6
2250	89	16.7	58.8	11.3	31	6.3
2500	79.5	20.7	46.1	12.5	23.7	6.9
2750	71.5	25.1	37.2	13.8	18.5	7.6
3000	65	30.0	29.9	15.0	14.3	8.3
3250	59.5	35.3	24.5	16.3	11	9.0
3500	54.6	41.1	19.8	17.5	8.3	9.7
3750	50.4	47.4	16.1	18.8	6.1	10.4
4000	46.7	54.2	12.9	20.0	4.1	11.1
4250	43.3	61.4	10.3	21.3	2.5	11.8
4500	40.33	69.2	7.9	22.5	1	12.5
4750	37.61	77.5	5.9	23.8		
5000	35.11	86.3	4.1	25.0		
5250	32.85	95.7	2.54	26.3		
5500	30.71	105.6	1.05	27.5		
5750	28.8	116.2				
6000	27	127.3				

# Suggested Load Data

Pre Galvanised 41x41x2.5mm slotted strut  
Loading Conditions: UDL

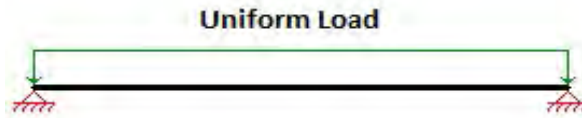
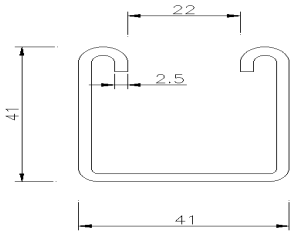

Slotted 41x41x2.5mm thick

Beam Span (mm)	Ultimate Loading		Limit Def. Span/200		Limit Def. Span/360	
	Total Applied Load (kg)	Total Def. (mm)	Applied UDL (KG)	Total Def. (mm)	Applied UDL (kg)	Total Def. (mm)
250	1620	0.3				
500	805	1.0				
750	540	2.3			490	2.1
1000	409	4.1			280	2.8
1250	328	6.4	321	6.3	177	3.5
1500	271	9.2	220	7.5	123	4.2
1750	231	12.5	160.9	8.8	86.8	4.9
2000	202	16.4	121	10.0	64.9	5.6
2250	178	20.7	93.8	11.3	49.6	6.3
2500	159	25.6	73.8	12.5	38	6.9
2750	143	31.0	59.4	13.8	29.3	7.6
3000	130.5	37.0	48	15.0	22.9	8.3
3250	119	43.4	39	16.3	17.6	9.0
3500	109.5	50.5	31.8	17.5	13.4	9.7
3750	101	58.0	25.8	18.8	9.75	10.4
4000	93.5	66.1	20.7	20.0	6.69	11.1
4250	86.8	74.7	16.4	21.3	4	11.8
4500	80.76	83.9	12.7	22.5	1.61	12.5
4750	75.4	93.7	9.5	23.8		
5000	70.5	104.0	6.6	25.0		
5250	65.9	114.8	4.05	26.3		
5500	61.75	126.3	1.7	27.5		
5750	57.85	138.3				
6000	54.31	151.0				